

Planning Permit No. C/PP/86/74  
**APPROVED**  
 SUBJECT TO THE CONDITIONS IN THIS OFFICE LETTER  
 No. C2/15/97/14 Date 30.8.94  
 FOR MEMBER SECRETARY  
 MADRAS METROPOLITAN DEVELOPMENT AUTHORITY  
 MADRAS - 600 008

SECTION 'A A'

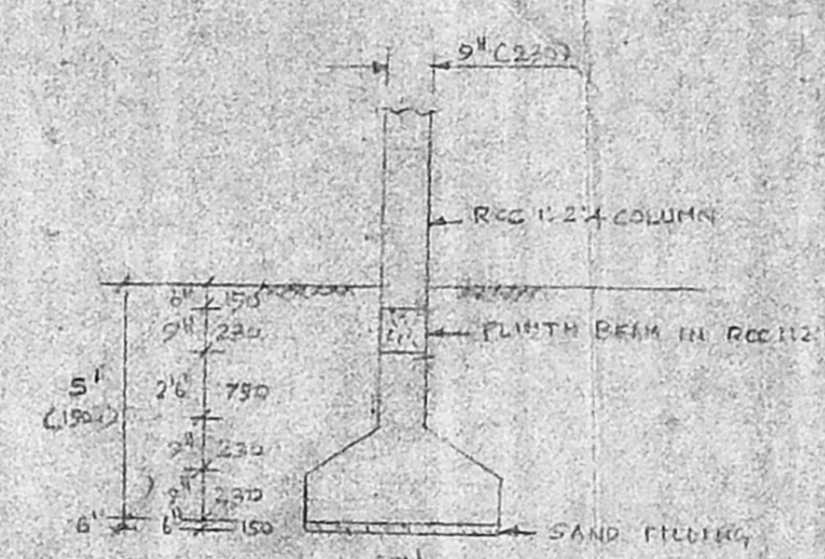

FOUNDATION DETAILS  
SCALE 1/50

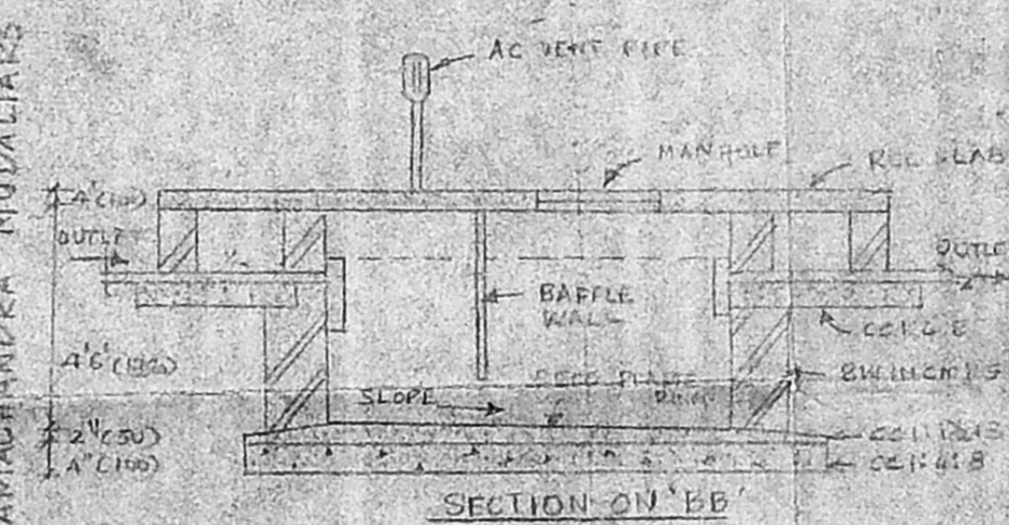

SECTION ON 'B B'

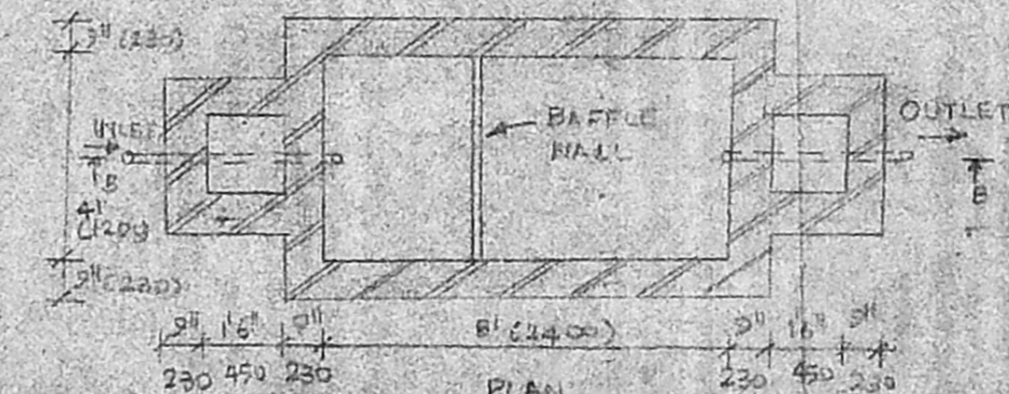

DETAILS OF SEPTIC TANK  
SCALE 1/50

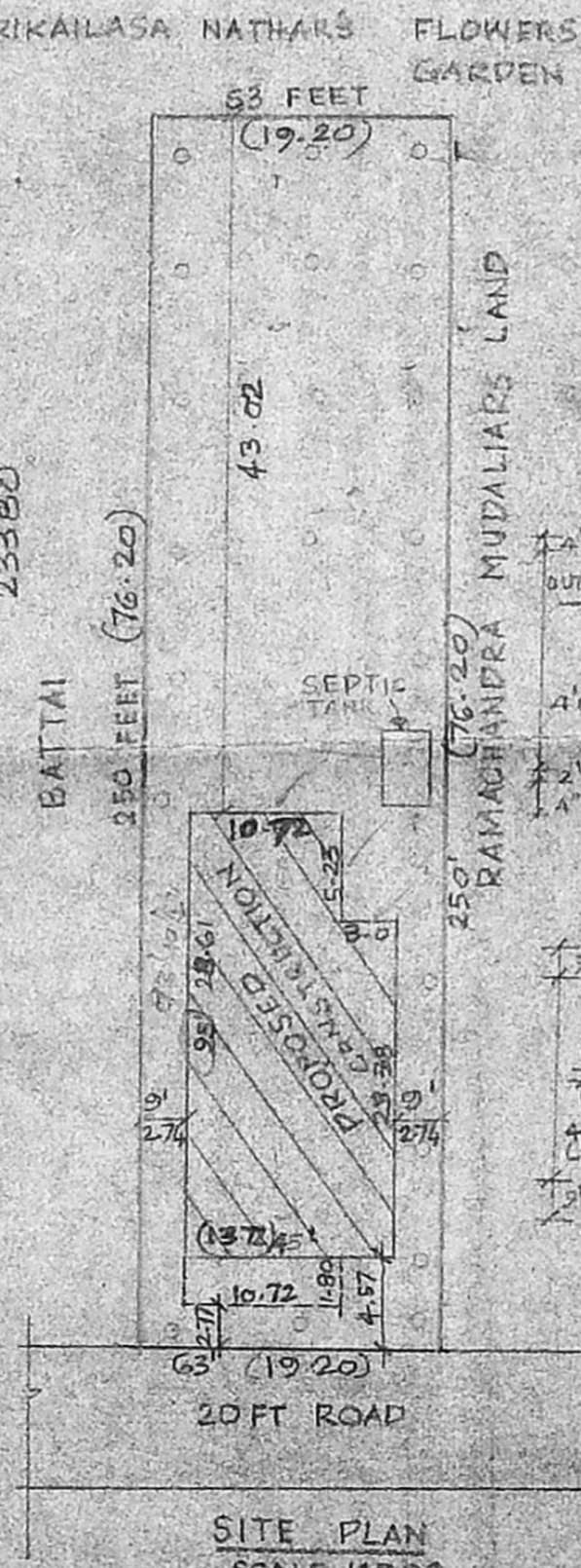

SITE PLAN  
SCALE 1/500

**SPECIFICATION:**  
 FOUNDATION: ISOLATED COLUMN FOOTING R.C.C. 1:2:4  
 PLINTH BEAM: R.C.C. 1:2:4, 230MM THICK ALROUND  
 BASEMENT: BRICK WORK IN CM 1:5  
 FLOORING: 20MM THICK 2-MIX OVER BASE COURSE OF P.C.G. 1:4:3  
 100 MM THICK OF MOSAIC FLOORING  
 SUPER STRUCTURE: BRICK WORK IN CM 1:5 USING FIRST CLASS BRICK (230MM) OF TRUCK  
 LINTEL: R.C.C. 1:2:4, 150MM THICK  
 ROOF SLAB: R.C.C. 1:2:4, 150MM THICK WITH WEATHERING COURSE  
 PLASTERING: CM 1:5, 12mm THICK  
 PARAPET WALL: BRICK WORK IN CM 1:5, 800mm HEIGHT

**SCHEDULE OF JOINERIES**  
 D - ALUMINIUM GLAZED DOOR: 1200 x 2100 - 4' x 7'  
 S.D. - ALUMINIUM SLIPING DOOR: 1200 x 2100 - 4' x 7'  
 P1 - COUNTRY WOOD PANELLED DOOR: 750 x 2000 - 2'6" x 6'6"  
 W - ALUMINIUM GLAZED WINDOW: 1200 x 1350 - 4' x 4'6"  
 V - GLAZED VENTILATOR: 900 x 600 - 3' x 2'

**DETAILS OF PLOT**  
 EXTENT OF PLOT: 15250 SQ/141750  
 PROPOSED CONN: 4875 SQ/27825  
 VACANT LAND: 10375 SQ/114000

**REFERENCES**  
 RED - PROPOSED CONSTRUCTION  
 ROAD  
 PLOT  
 ALL DIMENSIONS IN METRE

**NOTE** 27 NOS OF RAIN WATER PERCOLATION SAND & STONE DRAINAGE SYSTEM IS PROVIDED. 12" DEPTH 300MM Ø BOREHOLE, BOTTOM 6" FILLED WITH 40MM HEG STONE & TOP 6" FILLED WITH COARSE SAND

**PROPOSED CONSTRUCTION OF MIDAS PLANT LABORATORIES AT NO 72 THARAPAKKAN VILLAGE SRIPERUMBUDUR TALUK, CHENGAI-M-G-R DISTRICT R.S.NO: 233/1**

Er. M. Ulaganathan, B.E., M.E.  
 Licensed Surveyor No. 250 OF Corporation of Madras.  
 12, Durasamy Mudali Street, KUNRATHUR, MADRAS-600 068